

Vande Hei Property

Deer Bow:
Sept. 18 - Nov. 18
Nov. 29 - Jan. 9

Deer Gun:
Nov. 20 - 28

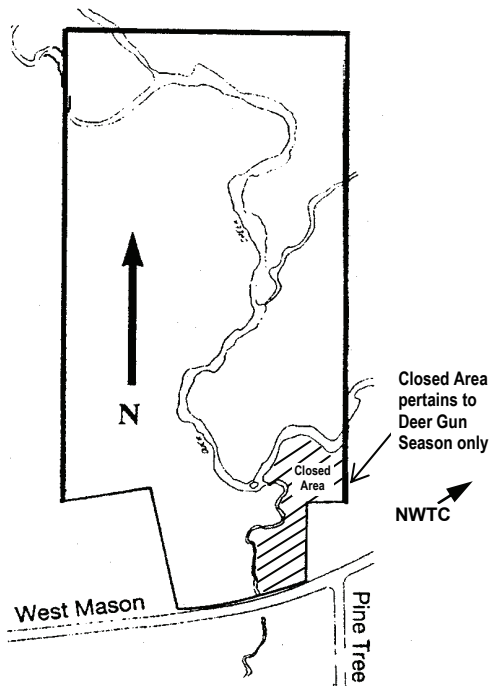

Brown County Solid Waste Town of Holland

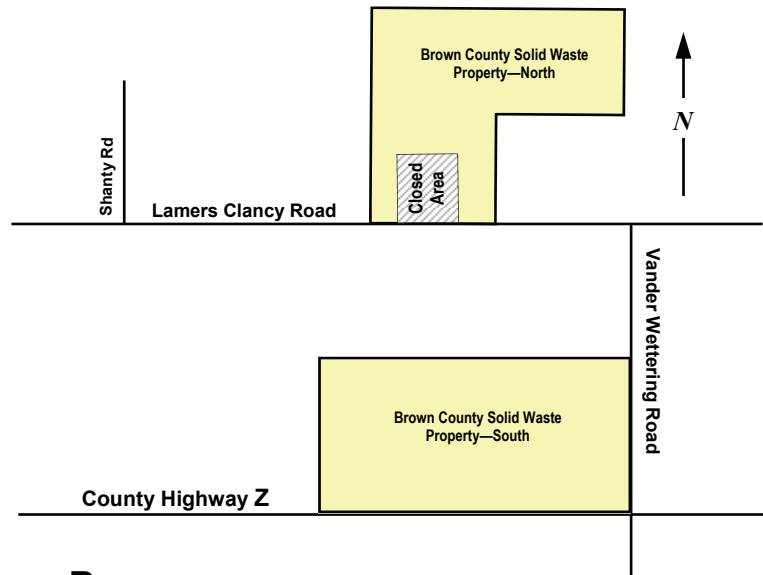

Deer Bow: Sept. 18 - Nov. 18
Nov. 29 - Jan. 9

Deer Gun: Nov. 20 - 28

For additional information on this property, call the Brown County Solid Waste Dept. at (920) 492-4950.

Hunting on County Park Lands - 2010

Six managed hunts for white-tailed deer are scheduled during the 2010 Wisconsin hunting season on Brown County park lands. In addition, waterfowl hunting will be permitted along the shoreline areas at the Fort Howard Paper Foundation Wildlife Area and Lily Lake Park during the regular waterfowl season. **Bag limits, daily hours, and licenses are in accordance with those rules and regulations established by the Wisconsin Dept. of Natural Resources.**

Additionally, there will be **NO** early goose, extended muzzle-loader, youth gun hunts or additional antlerless deer gun hunts on any park properties. All other park lands, except those specified in this brochure, will be closed to hunting during the 2010 season. **The WDNR season dates in this brochure may change due to pending rule changes—please contact the DNR for up-to-date info. Note that archery season closes with the Statewide Closure even though some Parks may be in metro units.**

Following is a summary of the regulations for those parks open to hunting during 2010:

1. Firearms & bows are permitted only in open areas only during specified times & dates.
2. Permanent blinds and stands are **not** permitted. All stands and blinds must be removed at the close of each day. Trees and vegetation cannot be removed.
3. Baiting allowed (or not allowed) per State DNR mandates. See current DNR regulations for baiting rules and regulations.
4. Possession of any firearm or bow, unless enclosed in a case or unstrung, is prohibited in any closed area.
5. Permission must be obtained from the Park Manager before pursuing any wounded game within a closed area.
6. **SMALL GAME HUNTING IS NOT PERMITTED ON ANY COUNTY PARK**

Hunters

Get your rifle sighted at the

Brown County Rifle Range

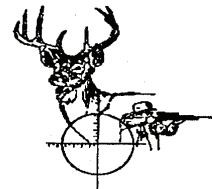

Open Dates and Hours:

September - Saturdays only
Beginning September 11
10:00 a.m. - 4:00 p.m.

October - Saturdays & Sundays
8:00 a.m. - 4:00 p.m.

November - Open Daily through Nov. 18
8:00 a.m. - 4:00 p.m.

\$5.00 per gun or person
Includes targets and assistance

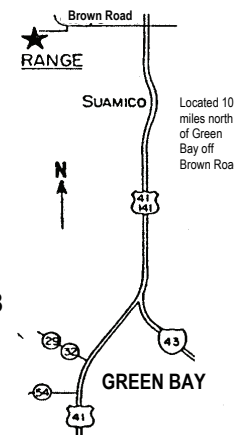

2010 HUNTING



Brown County Park System



Brown County Facility & Park Management
325 E. Walnut Street
Green Bay, WI 54301
(920) 448-4466

Reforestation Camp

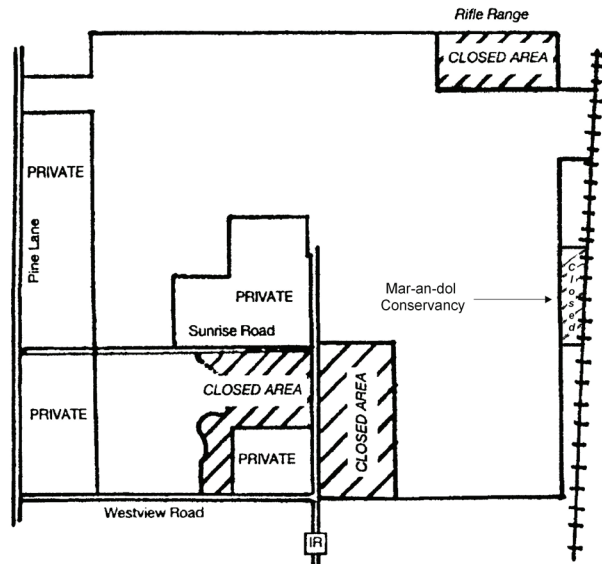

Deer Bow: Sept. 18 - Nov. 18 (early season only)
Deer Gun: Nov. 20 - 28

Neshota County Park

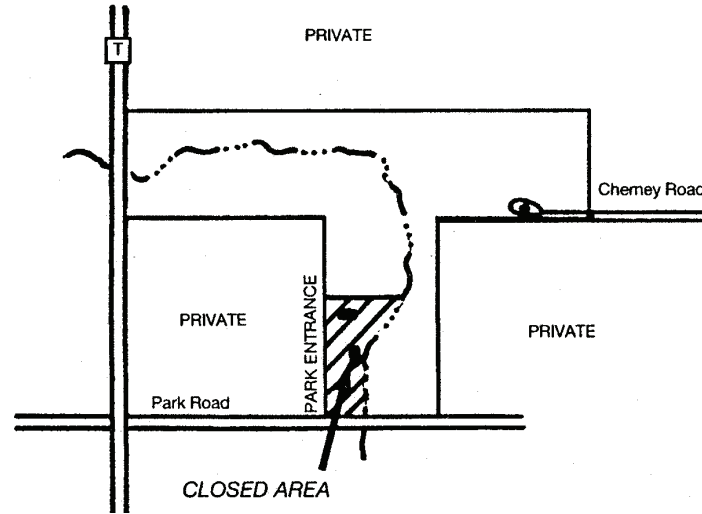

Deer Bow Only:
 Sept. 18 - Nov. 18
 Nov. 29 - Jan. 9

Barkhausen Waterfowl Preserve and Ft. Howard Paper Foundation Wildlife Area

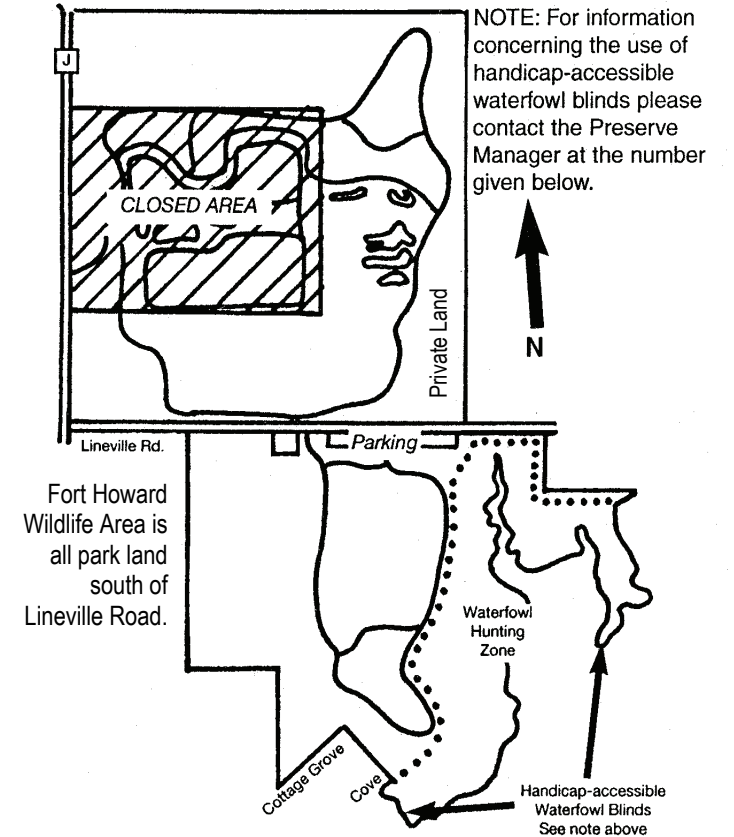

Fort Howard Wildlife Area is all park land south of Lineville Road.

Open for waterfowl hunting during regular season only (consult DNR hunting pamphlet for dates) and only in designated waterfowl hunting zone as indicated on map.
No early goose season allowed.

Deer Bow:
 Sept. 18 - Nov. 18 **Ft. Howard Wildlife Area Only**
 Nov. 29 - Jan. 9 **Both properties**

Deer Gun:
 Nov. 20 - 28 **By Special Permit Only**
 (Apply Aug 1 - 15)

For more information on this property contact the Preserve Manager at (920) 434-2824.

Lily Lake County Park

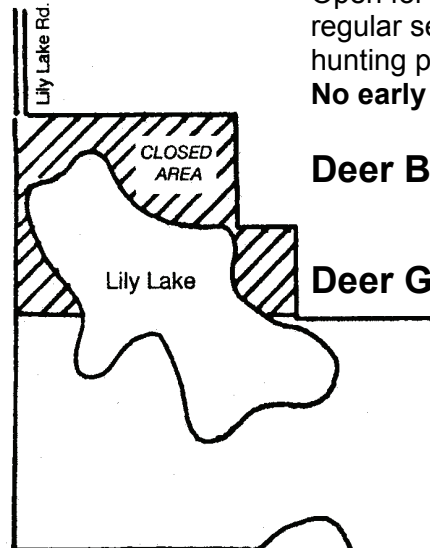

Open for waterfowl hunting during regular season only (consult DNR hunting pamphlet for dates).
No early goose season allowed.

Deer Bow: Sept. 18 - Nov. 18
 Nov. 29 - Jan. 9

Deer Gun: Nov. 20 - 28

Fonferek's Glen

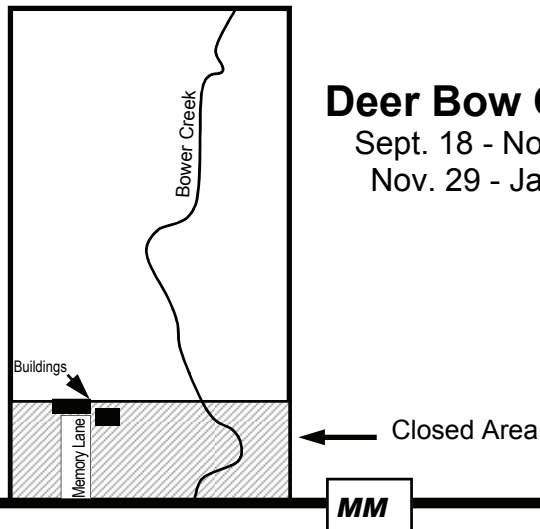

Deer Bow Only:
 Sept. 18 - Nov. 18
 Nov. 29 - Jan. 9